



Light Shadow Spot 30

LED accent lighting module for installation in The Tracking Magnet or Infra-Structure systems.

Description

A range of spots that offers the exclusive and patented Flos technology for its Light Shadow family of luminaires, with double focal lenses and high shielding optical body and maximum visual comfort. The unbeatable treatment of the raw light source flux results in an excellent Light Output Ratio in any of its beam angles. This, together with an even and impeccable light distribution, makes this family of spotlights the perfect lighting tool for the most demanding professional projects.



Lamp

Lamp Type	Power LED
Wattage	4W
Initial Lumens	298 lm / 318 lm
Color Temperature	2700K / 3000K
Color rendering	CRI 90

Optical

Beam Angle	S - 11° / M - 22° / F - 29° / WF - 43°
Lighting Type	Direct
Light Distribution	Symmetric

Physical

Material	Aluminum
Aiming	Adjustable
Weight	0.3 Lbs
Ingress Protection Rating	IP20
Maximum tilt Angle	90°
Rotation	360°

Finishes	<input type="checkbox"/> 40 White	<input type="checkbox"/> 14 Black	<input type="checkbox"/> ER = Brushed Steel	<input type="checkbox"/> ES = Brushed Bronze
----------	-----------------------------------	-----------------------------------	---	--



Dimensions

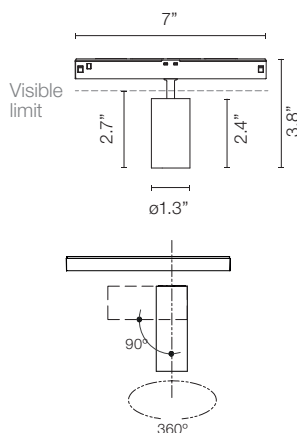

Certifications



Photometrics

For current IES files please visit arch.flosusa.com

Warranty

2 years from date of sale.



Light Shadow Spot 30

LED accent lighting module for installation in The Tracking Magnet or Infra-Structure systems.

Electrical & Control

Driver location	Remote
Driver Input Voltage	120V-277V
Forward Voltage	48V
Current mA	900mA
Control	Dimmer on Board, 1-10V, DALI, Casambi
Class	2

Performance

Maximum delivered output	up to 257 lm / up to 274 lm
Efficacy	68.5 lm/W

Dimensions

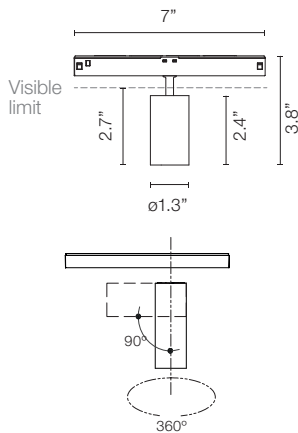

Certifications



Photometrics

For current IES files please visit
arch.flosusa.com

Warranty

2 years from date of sale.



Light Shadow Spot 30

LED accent lighting module for installation in The Tracking Magnet or Infra-Structure systems.

How to specify

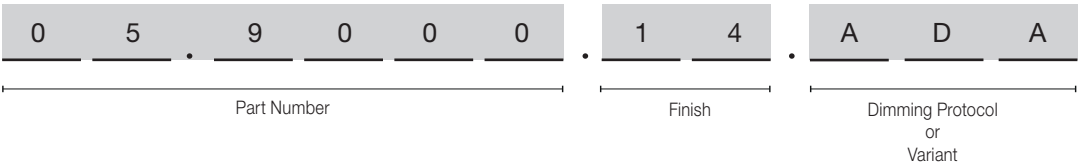

CCT	CRI	Initial Lumens	Delivered Lumens	Watts	Beam Spread	Part Number	Finish	Dimming Protocol
3000	90	318	270	4	11°	05.9005	<div> <div>40 = White</div> <div>14 = Black</div> <div>ER = Brushed Steel</div> <div>ES = Brushed Bronze</div> </div>	A = Dimmable on Board A1V = 0-10V, 10% Dimming ACB = Dimmable Casambi ADA = DALI, 10% Dimming
2700	90	298	253	4	11°	05.9000		
3000	90	318	274	4	22°	05.9006	<div> <div>40 = White</div> <div>14 = Black</div> <div>ER = Brushed Steel</div> <div>ES = Brushed Bronze</div> </div>	A = Dimmable on Board A1V = 0-10V, 10% Dimming ACB = Dimmable Casambi ADA = DALI, 10% Dimming
2700	90	298	257	4	22°	05.9001		
3000	90	318	263	4	29°	05.9007	<div> <div>40 = White</div> <div>14 = Black</div> <div>ER = Brushed Steel</div> <div>ES = Brushed Bronze</div> </div>	A = Dimmable on Board A1V = 0-10V, 10% Dimming ACB = Dimmable Casambi ADA = DALI, 10% Dimming
2700	90	298	246	4	29°	05.9002		
3000	90	318	262	4	43°	05.9008	<div> <div>40 = White</div> <div>14 = Black</div> <div>ER = Brushed Steel</div> <div>ES = Brushed Bronze</div> </div>	A = Dimmable on Board A1V = 0-10V, 10% Dimming ACB = Dimmable Casambi ADA = DALI, 10% Dimming
2700	90	298	246	4	43°	05.9003		

Light Shadow Spot 30

LED accent lighting module for installation in The Tracking Magnet or Infra-Structure systems.

Photometric Light Shadow Spot 30

Spot 10°
2700K

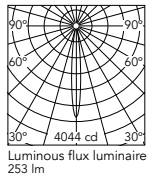

Beam Angle: 11°

h(m)	E(lx)	D(m)
1	4044	0.20
2	1011	0.40
3	449	0.60
4	253	0.80
5	162	1.00

3000K

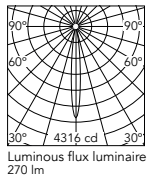

Beam Angle: 11°

h(m)	E(lx)	D(m)
1	4316	0.20
2	1079	0.40
3	480	0.60
4	270	0.80
5	173	1.00

Medium 22°
2700K

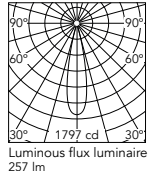

Beam Angle: 22°

h(m)	E(lx)	D(m)
1	1797	0.39
2	449	0.78
3	200	1.17
4	112	1.56
5	72	1.95

3000K

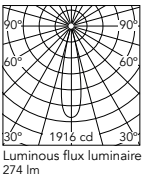

Beam Angle: 22°

h(m)	E(lx)	D(m)
1	1916	0.39
2	479	0.78
3	213	1.17
4	120	1.56
5	77	1.95

Flood 33°
2700K

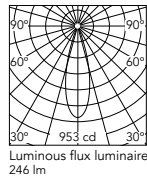

Beam Angle: 29°

h(m)	E(lx)	D(m)
1	953	0.52
2	238	1.04
3	106	1.57
4	60	2.09
5	38	2.61

3000K

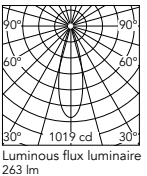

Beam Angle: 29°

h(m)	E(lx)	D(m)
1	1019	0.52
2	255	1.04
3	113	1.57
4	64	2.09
5	41	2.61

Wide Flood 46°
2700K

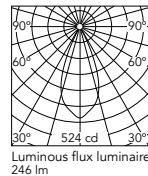

Beam Angle: 43°

h(m)	E(lx)	D(m)
1	524	0.80
2	131	1.59
3	58	2.39
4	33	3.19
5	21	3.99

3000K

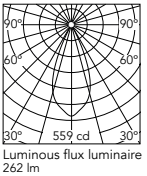

Beam Angle: 43°

h(m)	E(lx)	D(m)
1	559	0.80
2	140	1.59
3	62	2.39
4	35	3.19
5	22	3.99

Optional Accessories Light Shadow Spot 30

Honeycomb

Part Number:

08.0790.00



Dicroic CCT Filter

INCREASE

2700K >> 3125±75K
3000K >> 3600±75K

Part Number:

08.0791.00



Dicroic CCT Filter

DECREASE

2700K >> 2450±75K
3000K >> 2700±75K

Part Number:

08.0792.00

